

SIMM Sockets

(Continued)

Dimensioning:
Dimensions are in inches and millimetres.
Values in brackets are metric equivalents.
Chart contains dimensions in inches over millimetres.

DIPLOMATE SIMM Low Profile (Angled) Sockets

Materials and Finish:

Housing—Polyphenylene sulfide, glass filled, UL 94V-0 or Liquid Crystal Polymer (LCP), glass filled, UL 94V-0
Contact—Beryllium copper, bright tin-lead or gold plating

Features

- Accepts standard JEDEC modules
- Card guides for mechanical stability
- Positive retention
- Polarization of socket to board
- Polarization of module to socket
- Slanted module mounting for low height
- Single and double row styles available
- Grip areas provided for robotic interface
- Mounts on .400 [10.16] (single row versions) or .500 [12.7] (double row versions) row-to-row centers

Benefits

- Provides optimum efficiency of height versus board space
- Allows retrofit of SIMM packaging into applications using .750 [19.05] board-to-board spacing

Single Row

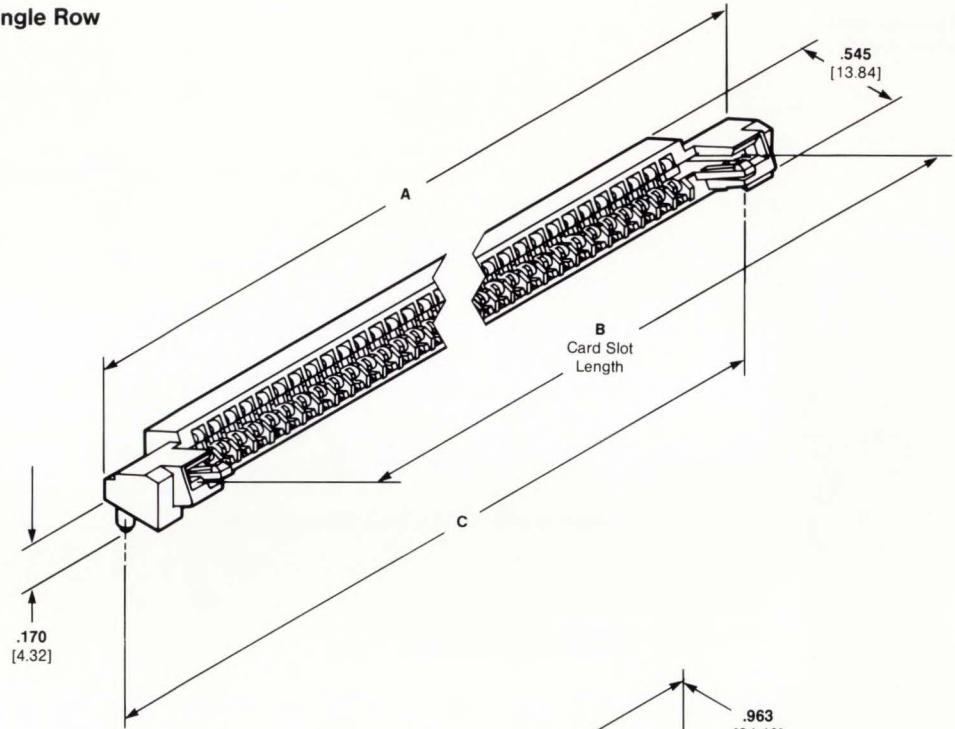

Double Row

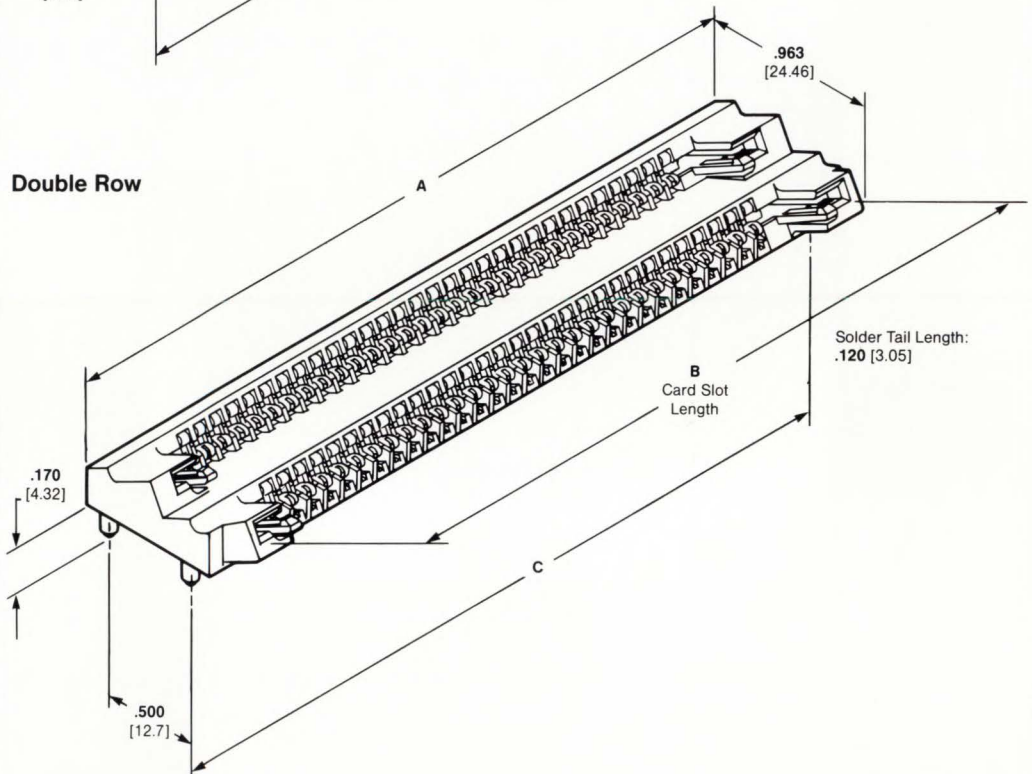

No. of Pos.	Dimensions			Part Numbers ¹			
	A	B	C	Single Row Slide Tray ⁴		Double Row Slide Tray ⁴	
				Tin ²	Gold ³	Tin ²	Gold ³
30	3.800 96.52	3.514 82.26	3.650 92.71	2-382030-1	2-382030-2	2-382130-1	2-382130-2
35	4.300 109.22	4.014 101.96	4.150 105.41	382035-1	—	—	—
42	5.000 127	4.714 119.74	4.850 123.19	382042-1	—	—	—

¹Other sizes and variations can be made available upon request.

²Bright tin-lead plate.

³0.000030 [0.00076] thick gold plate.

⁴Packaged in slide tray for robotic assembly.

Note: See page 32 for module layout and pc board patterns.

SIMM Sockets (Continued)

Dimensioning:
Dimensions are in inches and millimetres.
Values in brackets are metric equivalents.
Charts contain dimensions in inches over millimetres.

Recommended Module Layout

No of Pos.	Dimension A
22	2.700 68.58
30	3.500 88.9
35	4.000 101.6
42	4.700 119.38

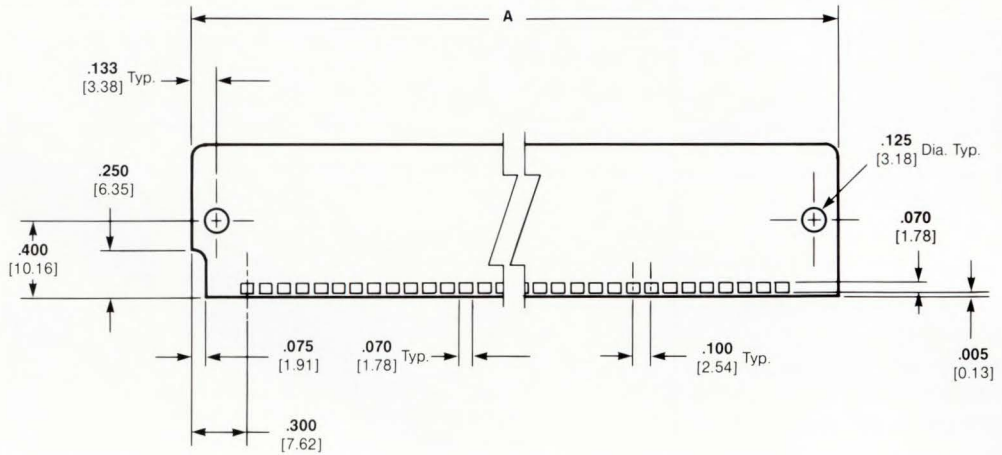

Thickness: $.050 \pm .003$ [1.27 ± 0.08] across pads.

Pc Board Hole Patterns

No of Pos.	Dimension A Standard Vertical and Low Profile Sockets
22	2.850 72.39
30	3.650 92.71
35	4.150 101.41
42	4.850 123.19

Dimension B:
.300 [7.62], .400 [10.16] or
.500 [12.7] depending on center-
line spacing of socket.

Single Row Sockets

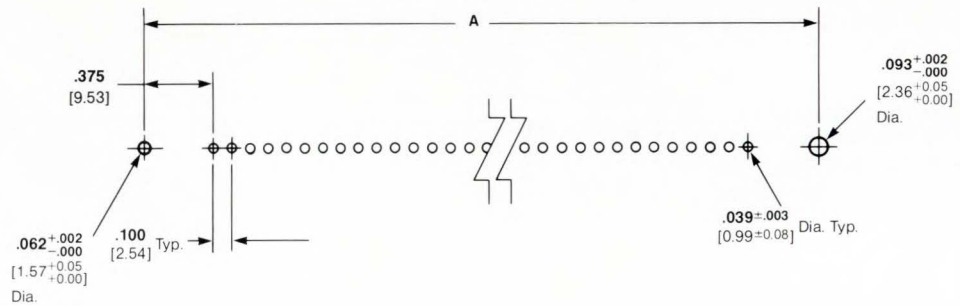

Double Row Sockets

